

**HEAVEN NIGHT CLUB**

10a The Arches, Villiers St, London, WC2N 6NG

Tel: +44 (0)20 7930 2020

Fax: +44 (0)20 7930 8306

Venue Technical Specification

CONTACTS	Page 1
VENUE INFORMATION (rental fees, stage crew, ticketing, transport, past events)	Page 2
LOAD IN (address, details, times, parking)	Page 3
STAGE (size, clearance, power, barrier, etc.)	Page 4
STAGE FLOOR PLAN	Page 4
LIGHTS (lighting bars, ground support, in house lighting, etc.)	Page 4
SOUND (curfew, in-house PA, mixer position, etc.)	Page 5
DOOR TIMES (incl. curfews)	Page 5
STAFF / CREW (security / stewards, local crew + technicians, box office, etc.)	Page 5
FACILITIES (dressing rooms, showers, production office, internet access, etc.)	Page 5
DETAILED VENUE TECHNICAL SPECIFICATIONS (power, light, sound, video)	Page 6
TECHNICAL DETAIL FOR ADDITIONAL ROOMS WITHIN HEAVEN	Page 9
DRESSING ROOMS	Page 10
HEAVEN WET RIDER PRICES	Page 11
BOX OFFICE	Page 12
FRONT OF HOUSE / MERCHANDISE	Page 13
AFTERSHOW PARTIES	Page 14

CONTACTS			
Mark Ellicott	General Manager / Booker	mark.ellicott@heavenlondon.co.uk	020 7930 2020
Stuart Turner	Deputy General Manager	stuart@heavenlondon.co.uk	
Marius Negraru	Bars Manager	bars@heavenlondon.co.uk	
Russell Peek	Day Manager	daytime@heavenlondon.co.uk	020 7930 2020
Boris Bosjnak	Production Manager	boris@heavenlondon.co.uk	
Joe Peet	Head of Audio	jo.peet@gmail.com	
Conor Vennard	Head of Lighting	conor.vennard@gmail.com	
Production Office			020 7389 6618
Production Office (fax)			020 7930 8306

VENUE INFORMATION	
Address:	10a The Arches, Villiers St, London, WC2N 6NG (map)
Rental:	<p>The Hire Fee for a basic 7pm – 11pm live event is £1000 plus VAT plus PRS verses £1.75 per head. For example if ticket sales are 800 the rental is £1400 plus VAT and if they're 450 the fee payable is the basic £1000 plus VAT plus PRS.</p> <p>The Hire Fee will include a full complement of security staff for the duration of the event. It also includes one Monitor and one FOH sound technician and a Lighting Technician working ten hour calls. For shifts lasting longer than that the Hirer is charged at the rate of £20.00 per hour per technician. Guest list and Box Office staff and use of our Mojo Stage Barrier are also included.</p>
Stage crew:	Stage hands are not provided as part of the hire fee. If you require us to book them on your behalf please speak with Mark. Rates for stage crew are £60 per person per load in / out.
Soundcheck curfew:	Soundchecks must have been concluded no later than thirty minutes prior to doors to allow for house technical staff a break.
Ticketing system:	The venue does not operate its own ticketing system. We allow the hirer to sell the full allocation of saleable capacity through their own ticket outlets. We will require a weekly sales report of tickets sold and then a sales manifest on event day.
Local transport links:	Embankment and Charing Cross Underground stations both 150 metres from venue. Numerous 24 hour bus routes available to all parts of Greater London from Trafalgar Square (200 metres) and The Strand (150 metres). British Rail Charing Cross (150 meters from Heaven) serving overland routes into Kent and Sussex. British Rail Waterloo (600 meters from Heaven) serving overland routes to all parts of the South and South West of England.
Live events:	<p>Since Heaven launched itself as a live music venue in January 2009 we have successfully staged more than four hundred live shows featuring amongst others Franz Ferdinand, The Cribs, Marmaduke Duke, Patrick Wolf, Jack Penate, The Rasmus, Backyard Babes, The Virgins, White Lies, Killing Joke, Little Boots, Enter Shikari, Throbbing Gristle, The Freemasons, Passion Pit, Silversun Pickups, White Denim, Master Shortie, Taking Back Sunday, Frankmusik, Temper Trap, Young Knives, The Foals, Basshunter, Natalie Imbruglia, The Rumble Strips, Bombay Bicycle Club, Fuck Buttons, Does It Offend You Yeah, Alpha Beat, 65 Days of Static, Manchester Orchestra, Bad Lieutenant, Oceansize, Fightstar, N*E*R*D, Ellie Goulding, Panda Bear, MGMT, Kasabian, Delphic, Yeasayer, Broken Social Scene, Crystal Castles, Lightspeed Champion, Caribou, Holy Fuck, A Place To Bury Strangers, Two Door Cinema Club, Beach House, Robyn, Django Django, Chromatics, Kindness, Polica, The Dandy Warhols, Archive, God Is An Astronaut, Disclosure, Owl City, Toy, Japandroids, Parov Stelar Band, Mayer Hawthorne, Tunng, CSS, The 1975, Tricky, Chris Carter and Cosey Fanni Tutti, Haim, These New Puritans, Flume, James Blake, John Grant, Theme Park, Wire, Camera Obscura, Jamie Lidell, Diiv, Awolnation, Everything Everything, Darwin Deez, Blood Red Shoes, King Charles, Hot Chip, Lucy Rose, Mika, Grimes, The Pains Of Being Pure at Heart, The Drums A-Ha, Interpol, The Wombats, Tame Impala, Lissie, Lykke Li, Fenech Soler, Liars, School of Seven Bells, Local Natives, Hercules & Love Affair, Metronomy, Gang Of Four, The Duke Spirit, Chapel Club, Go! Team, Naked and Famous, Black Angels, Public Image Ltd, Santigold, WU LYF, fun., Oh Land, Azealia Banks, Azari & Ill, Black Lips, Sleigh Bells and Les Savy Fav.</p>

LOAD IN

Load in address:	180 - 182 Hungerford Lane, London, WC2N 5NG (map)
Load in details:	Access via Craven Street - Height restriction 2.9m / 9ft6". Larger lorries / bus unload top of Craven Street. <u>No movement of heavy vehicles (artics / coaches) between the hours of 00:30 - 07:00.</u> Stage Bar used as storage for live band shows. To be clear by 23:00 on curfew nights.
Load in times:	From 1pm - earlier by arrangement.
Parking:	We have spaces for the following: <ul style="list-style-type: none"> • 1 x Splitter type van • 1 x Saloon car

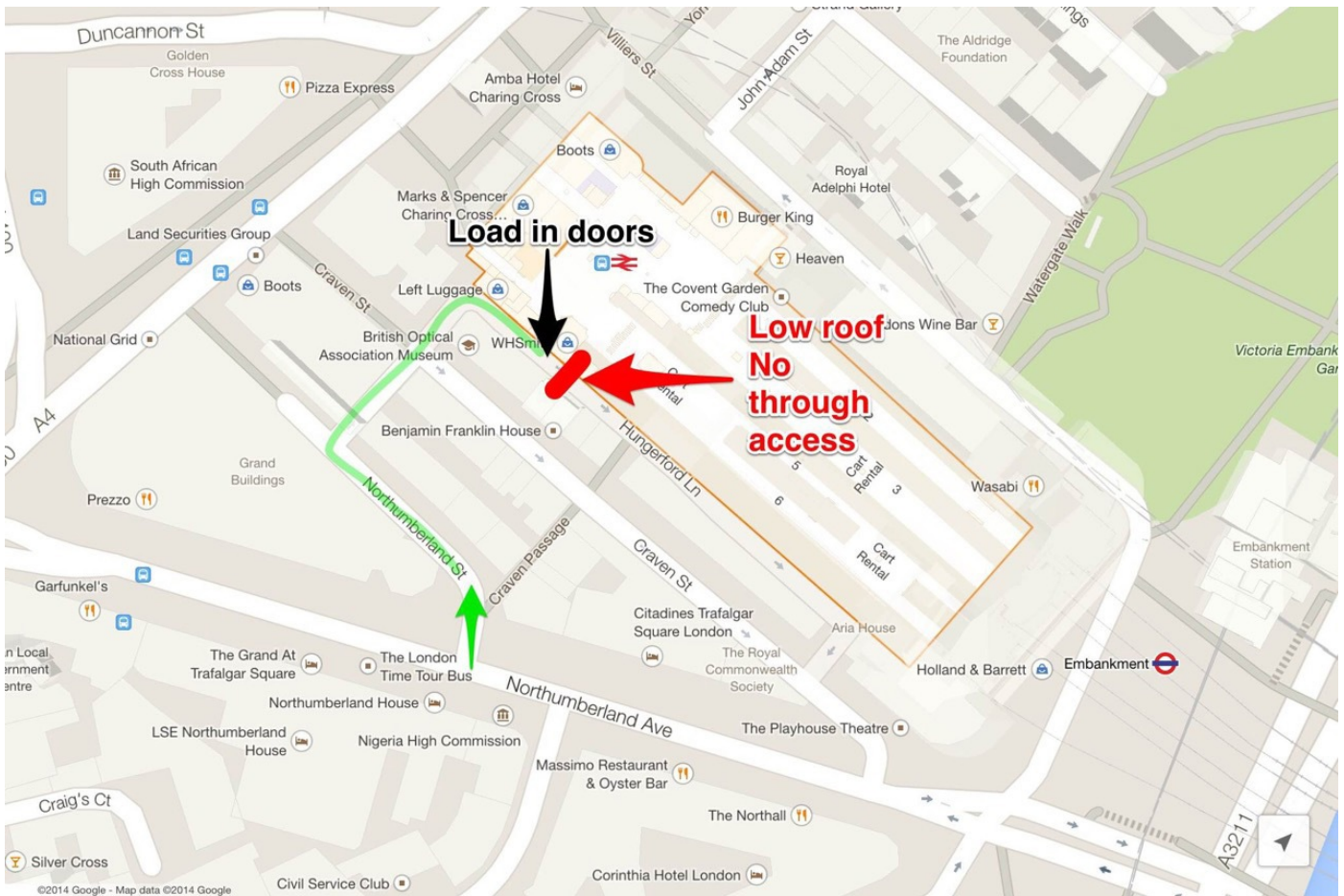

STAGE	
Size:	Depth Approx: 5.5m Width Approx: 4.8m There are fire escape routes down either side of the stage. Both need to be kept free of obstruction during live performances on stage. Please See Below
Clearance:	Stage height at sides 3m rising to approx 4.8m at middle of arch.
Flying points:	None.
Power:	<ul style="list-style-type: none"> • 1 x 32a single phase Ceeform • 1 x 63a single phase Ceeform • 1 x 125a three phase Ceeform
Barrier:	Mojo Stage Barrier provided by venue and included in hire fee.
Cable run from stage:	40 meters to FOH.
Special effects:	Please give up to four weeks notice for the use of certain special effects. It may be that we need to obtain authorisation for their use by Westminster Council.

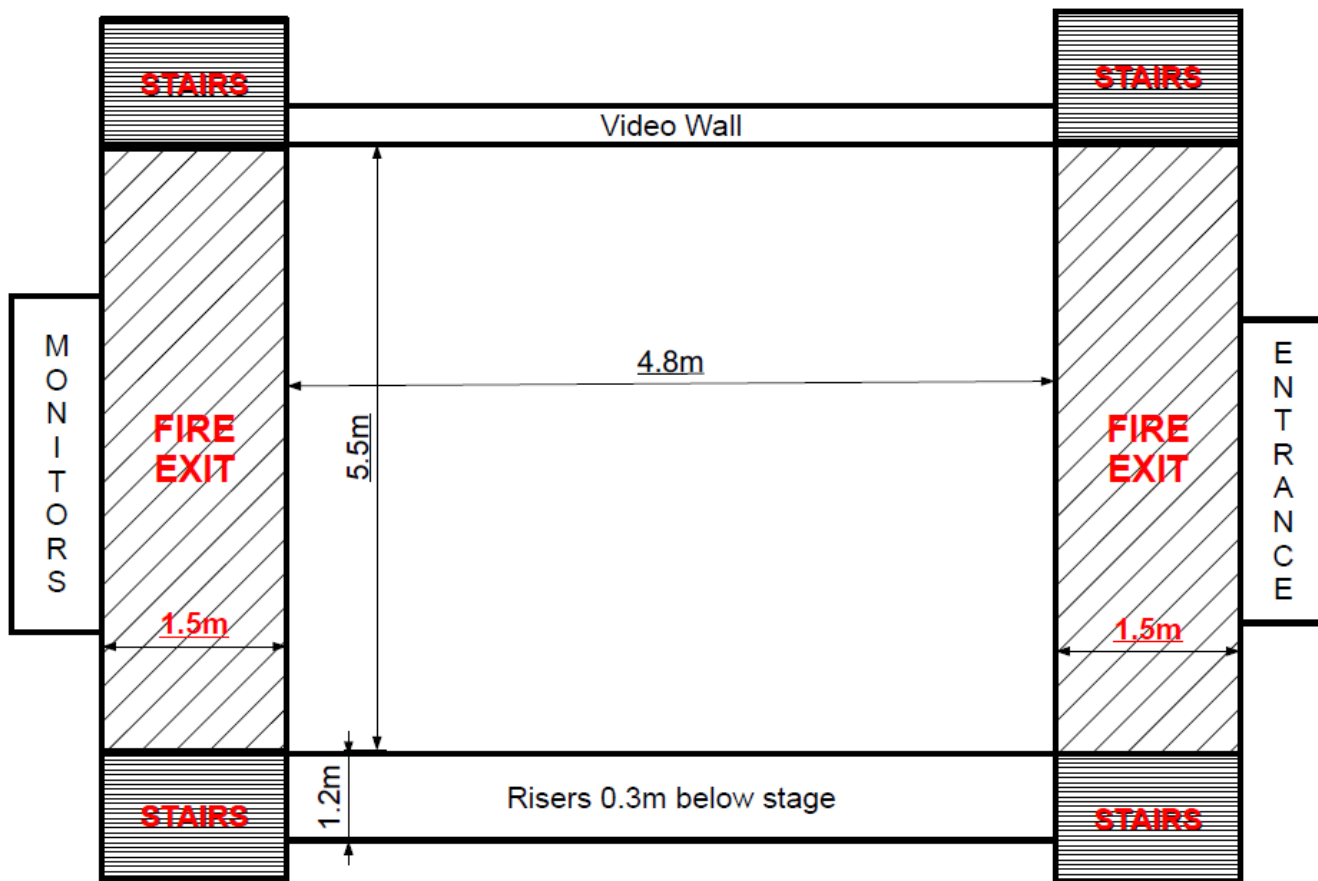

LIGHTS	
Lighting bars:	One at back of stage; One at front of house. Please contact Head of Lighting for up to date plan.
Ground Support required?	Please contact Head of Lighting.
In-house lighting:	Yes, please see page 7.
Follow spots:	None.

SOUND

Noise curfew:	None.
In-house PA:	Yes.
Mixer position:	Stage right and balcony of Main room.
PA stack position:	SL and SR.
House risers:	Yes - please ask.
Decks/Club PA:	Yes.

DOOR TIMES

Usual door opening time:	19:00, but can be earlier or later by arrangement.
Curfew times:	The following curfews apply for live gigs on those nights there are subsequent clubs events: Mondays, Fridays & Sundays: 22:15 Thursdays: 22:00 Saturdays: Not available for hire Tuesdays & Wednesdays: No Curfew

STAFF / CREW

Security / Stewards:	Venue will supply, included in hire fee.
Local Crew and Sound / Lighting Technicians:	The Venue will supply one Monitor and one FOH technician working a ten hour shift as well as a Lighting Technician working the same. Thereafter the Hirer will be charged an overtime rate of £20.00 per hour per technician. The Venue does not supply stage hands although we can arrange this on your behalf if you so wish. You would be charged £60 per stage hand per load in (out) assuming the load in / out was undertaken in less than five hours.
Box Office / Guest List person:	Venue will supply 2 people, included in hire fee.

FACILITIES

Principle Green Room / Headlining Band dressing room:	Situated above the Stage Bar.
2 x Support Band dressing rooms:	Situated in the Fourth Arch Staff Corridor.
Showers:	Available adjacent to the Support Band dressing rooms. Towels available from venue if required.
Production office:	Yes.
Internet access:	Wireless broadband available in Production Office and all dressing rooms. Please ask for password.
Catering:	We do not have catering facilities on site.
Parking:	We have spaces for the following at the rear of the venue: <ul style="list-style-type: none"> • 1 x Splitter type van • 1 x Saloon car

Detailed Venue Technical Specification

POWER SPECIFICATION

Power on stage:	<ul style="list-style-type: none"> • 1 x 125a three phase Ceeform (lighting) • 1 x 63a single phase Ceeform (sound) • 1 x 32a single phase Ceeform • (Power located upstage left) • (Distro not supplied by venue)
------------------------	---

FRONT OF HOUSE SYSTEM

- 10 x Funktion One Res 5 cabinets (Main PA: 3 SL, 3 SR Mid-Room Delay Fills 2 SL, 2 SR)
- 12 x Funktion One 218 Bass Enclosures
- 2 x Infra Bass 218 with Infrahorn
- 2 X Funktion One Res2 SH In-Fills
- 2 X Funktion One F88 Rear Bar Fills
- Control - XTA crossovers
- Amplification -QSC powerlight series and MC2 E series
- Mixing console – Digidesign Venue Mix Rack System: w/3 DSP cards, Firewire 400 x2 for 32 channels i/o

MONITOR SYSTEM

Floor Monitor / Stage Speakers:	<ul style="list-style-type: none"> • 10 x Turbosound TFM450 • 2 x Turbosound Aspect TA500 Side Fills • 2 x Turbosound TA880L 15" bass • 1 x Turbosound B18 Sub Drum fill (6 wedge mixes including CUE + Drum Fill + Sidefills)
Amplification and Control:	Turbosound T series Amplifiers and Turbosound LMS Processing
Mixing Console:	Digidesign Venue Mix Rack System w/3 DSP cards
IEM SYSTEMS	4 x Sennheiser G3 IEM systems

MICS, STANDS, DI'S

- 12 x BSS AR133 DI boxes
- 8 x Shure SM58
- 1 x Shure Beta58a
- 8 x Shure SM57
- 1 x Shure Beta57
- 2 x Shure Beta52
- 1 x Shure Beta91
- 4 x Sennheiser E604
- 3 x Sennheiser E904
- 8 x AKG C451B/ST
- 1 x Beyerdynamic M88 TG
- Assorted stands - short, tall, and round based.
- 5 x K&M Microphone stand with medium round base, black

Radio Mics

4 x Shure Beta58a UR2 tx, 4ch. x UR4D+ rx, 2x UA874E Active Antenna

DJ EQUIPMENT

- 1 x Pioneer DJM2000 Mixer
- 1 x Pioneer DJM1000 Mixer
- 2 x Pioneer DJM900Nexus Mixer
- 2 x Funktion One Formula sound mixer
- 10 x Pioneer CDJ2000
- 2 x Pioneer CDJ900

LIGHTING (FOH/DANCE FLOOR)

- 1 x Avolites Sapphire Touch
- 6 x Robin Pointe
- 4 x Source 4 Pars (floor blinders)
- 1 x Mirror ball
- 2 x Martin Atomic 3000

LIGHTING (STAGE)

- 6 x Source 4 750w (4 x 19°, 2 x 26°)
- 4 x 4 x 1000w Short nose parcan
- 4 x Robe Pointe
- 8 x Chauvet Legend 412
- 6 x Chauvet 560Z Q-Wash
- 1 x Unique 2 Haze
- 2 x Martin Atomic 3000 Strobes
- 4 x 2-lite moles

VIDEO EQUIPMENT**Video Equipment:**

- 2 x DVD player
- 1 x Kramer 8 x 8 video matrix switcher
- 1 x 9mm Viss LED Screen (4.8m x 3m)
- 1 x Hippo Amber Media Server
- 1 x LED screen input switcher
- Assorted screens of varying sizes

Visual Mixer:

None in-house.

Heaven Lighting Grid

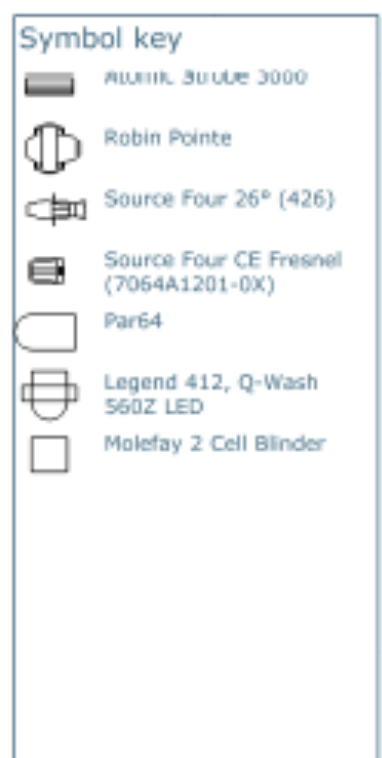
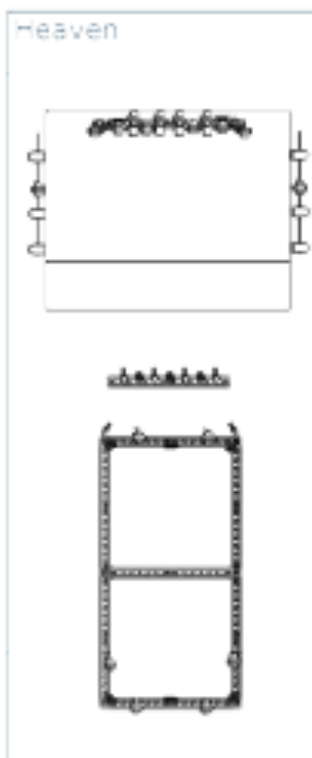
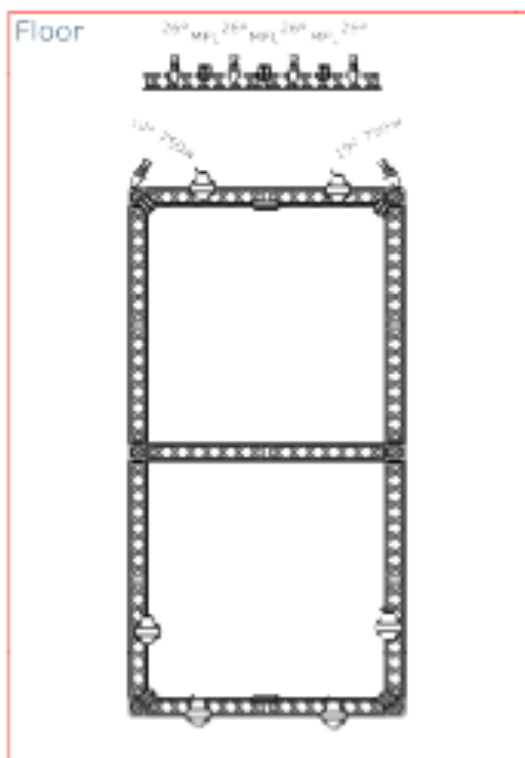
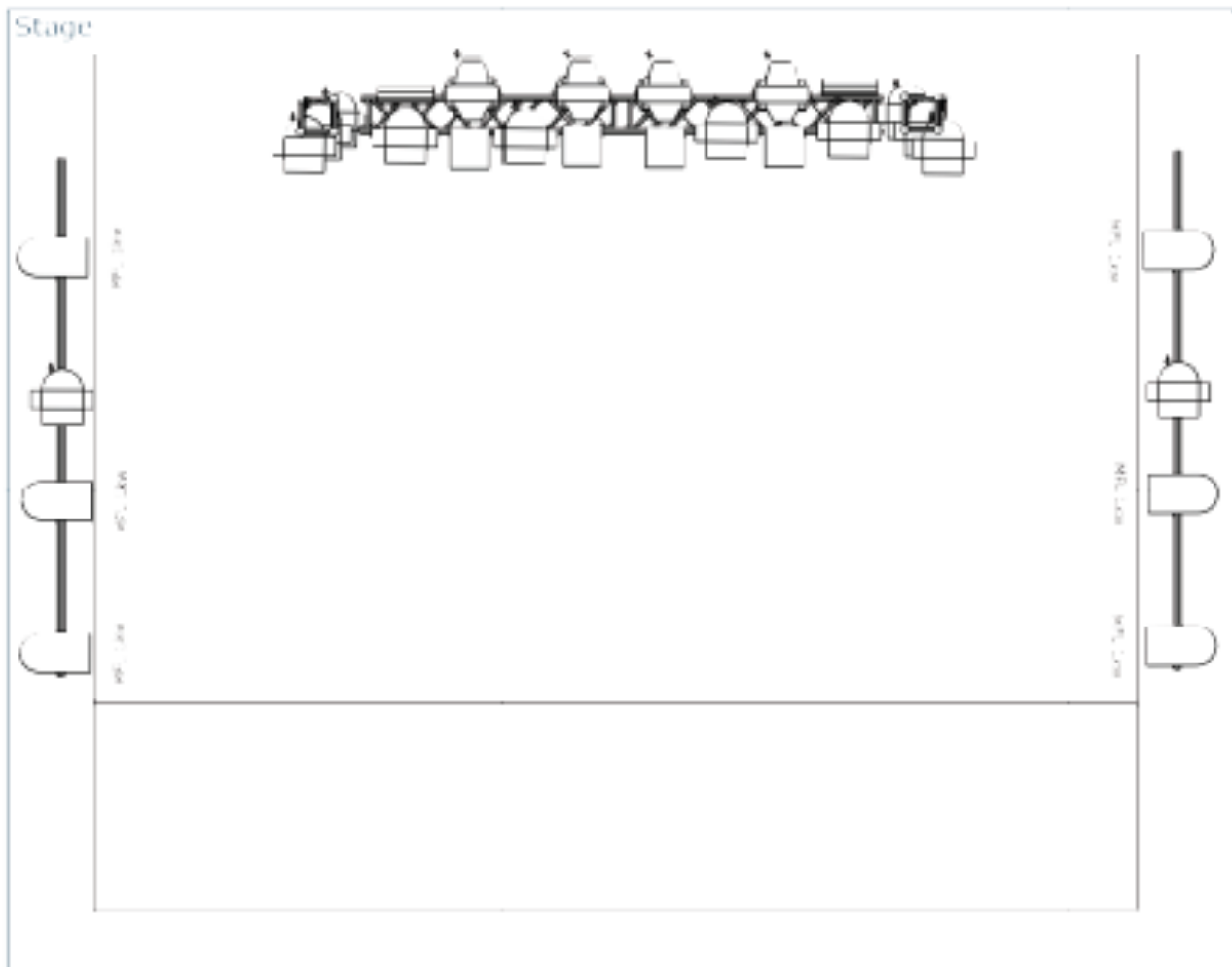

Technical Detail for Additional Rooms within Heaven

STAR BAR	
Lighting:	<ul style="list-style-type: none"> • 1 x Avolites Titan One • 6 x Robe 250 Scans • 12 x Pulsar LED Batons • 6 x 1k Parcans • 2 x Source 4 750w • 1 x Unique 2 Haze • 3 x Chauvet Radius 2.0
Sound (club system):	<ul style="list-style-type: none"> • 8 x TurboSound TSW 718 Subs • 8 x TurboSound TFL 760 HS • XTA C2 Compressor • BSS OmniDrive • Crest Audio Amps
Sound (speech / conference system):	<ul style="list-style-type: none"> • 4 x Bose 802 MK2 • 2 x TurboSound Impact 50 • RANE ME15B GEQ • BOSE 802 C System Controller • QSC Powerlight 2 3600 Watt

STAGE BAR	
Lighting:	<ul style="list-style-type: none"> • 1 x Avolites Titan One • 4 x Robe 250AT Spots • 12 x Anolis LED Strips • 2 x Pin Spot • 1 x Mirrorball • 1 x Chauvet Arena 2 haze
Sound:	<ul style="list-style-type: none"> • 4 x Res 2 SH Tops • 2 x FUNKTION ONE F218 subs • 2 x FUNKTION ONE F118 subs • XTA DP 226 • FUNKTION ONE E25 tops • Crest Audio 7001 subs / FUNKTION ONE T25 subs

DEPARTURE LOUNGE	
Lighting:	<ul style="list-style-type: none"> • 12 x Pulsar LED Batons • 2 x Pin spot • 1 x Mirrorball • 1 x 1000w Parcan • 1 x 6 channel dimmer • 1 x Projector + motorised screen
Sound:	<ul style="list-style-type: none"> • 4 x HK IL 12.1 • 2 x TurboSound TSW 718 Subs • Sound Craft F1 12 Channel Mixer • Turbosound LMS-700 • 3 x Crest Audio 4601

BALCONY - MAIN ROOM	
Sound:	<ul style="list-style-type: none"> • 2 x TurboSound TCS-122 • TurboSound LMS D24 • Crest Audio

Dressing Rooms

DRESSING ROOMS SUMMARY	
Capacity Stage Left:	30
Capacity 4th Arch:	14
Total:	44

STAGE BAR MEZZANINE DRESSING ROOM (DRESSING ROOM NO. 1)	
Location:	Mezzanine - Green Room
Capacity:	30
Size:	7m x 3.3m
Bathroom:	Yes.

DRESSING ROOM NO. 1	
Location:	Staff Corridor
Capacity:	8
Size:	5.4m x 3.6m
Bathroom:	Adjacent

DRESSING ROOM NO. 2	
Location:	Staff Corridor
Capacity:	6
Size:	5.4m x 3m
Bathroom:	Adjacent

SHOWERS / TOILETS	
Showers:	Adjacent to Dressing Rooms 1 & 2. Towels available from venue if required.
Toilets:	Available in Stage Bar Mezzanine dressing room and adjacent to Dressing Rooms 1 & 2.

For all queries regarding dressing rooms contact:

Mark Ellicott (General Business Manager) / Russell Peek (Day Manager).

Heaven Wet Rider Prices (April 2015)

BOTTLES / CANS (PER CASE)	
Stella	£28.00
San Miguel Fressca	£20.00
San Miguel (can)	£21.00
Smirnoff Ice	£28.00
WKD	£28.00
Gaymer's Apple / Pear	£20.00
Corona	£28.00
Peroni	£28.00
Budweiser	£30.00
Carlsberg	£12.00

SOFT DRINKS (PER CASE)	
Pepsi / Pepsi Max	£19.00
Water	£9.00
Gatorade Energy Drink	£21.00
Red Bull	£21.00
7Up	£19

WINE (PER BOTTLE)	
Barefoot Pinot Grigio	£5.00
Barefoot Zinfandel Rose	£5.00
Barefoot Merlot	£5.00

CHAMPAGNE (PER BOTTLE)	
Moet	£28.00
Veuve Clicquot	£29.00
Bollinger NV	£36.00
Proseco / Proseco Rose	£8.00

SPIRITS (PER 700ML)	
Red Square Vodka	£10.00
Smirnoff Red	£13.00
Jack Daniels	£18.00
Southern Comfort	£17.00
Bell's Whisky	£15.00
Highland Poacher Whisky	£11.00
Gordon's	£14.00
Bombay	£17.00
Johnnie Walker	£22.00
Black Sambuca	£16.00
Tanqueray Gin	£17.00
Belgravia Gin	£10.00
Captain Morgan	£14.00
Bacardi White Rum	£15.00
Expedition White Rum	£10.00
Malibu	£12.00
Courvoisier	£19.00
Baronet Brandy	£10.00
Disaronno	£16.00
Tequila	£17.00
Jagermeister	£16.00
Luxardo White Sambuca	£15.00
Archers	£11.00
Grey Goose Vodka	£25.00
Patron Coffee Tequila	£25.00

Please note that rider prices may change in the future. Please ask for confirmation.

Box Office

CAPACITY - LIVE GIGS (GROUND FLOOR & BALCONY ONLY) [STANDING ONLY]	
Ticketed admissions:	1100
Guests:	100
Total:	1200

CAPACITY - CLUB NIGHT (ALL ROOMS) [STANDING ONLY]	
All admissions including guests:	1625
Venue allocation:	30
Total:	1595

For all queries regarding ticketing, as well as website/marketing contact:

mark.ellicott@heavenlondon.co.uk Tel: 020 7930 2020

Front of House / Merchandise

Merchandise Concession Agreement

Heaven does not charge a merchandise commission. We do not generally supply staff for this and it would be expected that the Hirer would arrange. If you do require us to organise staff for this please advise us in good time. The location of the merchandising retail area is inside one of two arches directly opposite the Main Bar in the Main Hall.

Aftershow Parties

Heaven has a VIP area suited to aftershow parties capable of taking up to 75 guests. Please speak with Mark Ellicott to arrange. Larger spaces are also available for larger events.